



**One body, two brains.
FLOWSIC600 Quatro**

Ultrasonic gas flow meter FLOWSIC600 Quatro:
Install once, measure twice

SICK
Sensor Intelligence.

When two gas customers share one single measuring station



Two gas flow meters in one body: the FLOWSIC600 Quatro

Durable as FLOWSIC600.

The FLOWSIC600 Quatro has the same legendary compact design as all products in the FLOWSIC600 family. This device will operate under environmental extremes of heat, ice, water and sand, as well as other adverse operating conditions.

It comes from SICK, an independent company with more than 30 years of technology leadership in ultrasonics.

If you want to measure earnings, instead of producing costs, the FLOWSIC600 Quatro is the solution.

FLOWSIC600 Quatro. Install once, measure twice.

This design significantly reduces the cost for installations that traditionally used two separate meters with their associated piping.

The FLOWSIC600 Quatro provides two fiscal meters for full redundancy and equal accuracy within one meter body. The primary benefit of this design is that two different companies can utilize one meter body, but have totally isolated electrical and electronic systems. This permits each company to compute flow with equal accuracy, but be totally independent of each other.

Additionally, should one of the electronics ever develop a problem, the secondary unit will continue to provide accurate measurement data.

Maximum accuracy, minimum maintenance.

The FLOWSIC600 Quatro measures flow with the well-proven 4-path Westinghouse chordal configuration. It uses superior sensor transducer technology that provides the highest accuracy, together with long-term performance stability. Combined with the fully automated meter self-diagnostics (monitoring and warning of all diagnostic parameters – a first in the industry), the result is a solution for gas metering that significantly reduces maintenance costs and measurement uncertainty. The FLOWSIC600 Quatro is also available as 8-path version for flow test facilities.

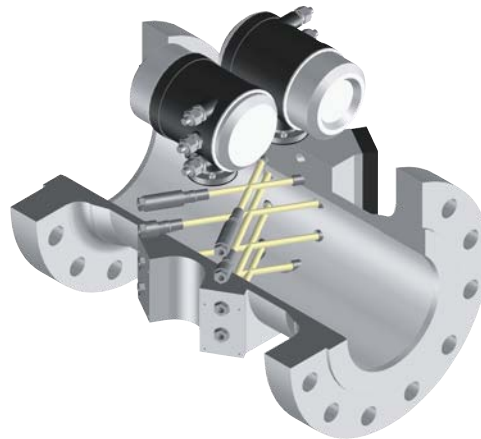

Two independent flow meters, each four-path, each custody approved