

# Drawings

## Model OR8EFG KCI Filling Type ORP Sensor

Unit : mm

- For FLXA402, PH202, FLXA202, FLXA21  
(OR8EFG - □□ - □□ - TT□ - E \* A)

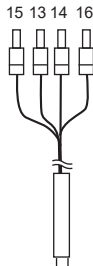

Cable gland is not included.  
Reuse existing gland, or replace.

- For FLXA402, PH450G, PH202/TB  
(OR8EFG - □□ - □□ - TT□ - G \* A)
- For FLXA202/FLXA21  
(OR8EFG - □□ - □□ - TT□ - F \* A)

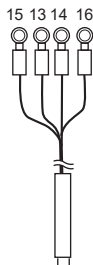

Cable gland is not included.  
Reuse existing gland, or replace.

- For OR100 (OR8EFG - □□ - □□ - TT□ - B \* A)
- For OR200/OR400 (OR8EFG - □□ - □□ - TT□ - N \* A)

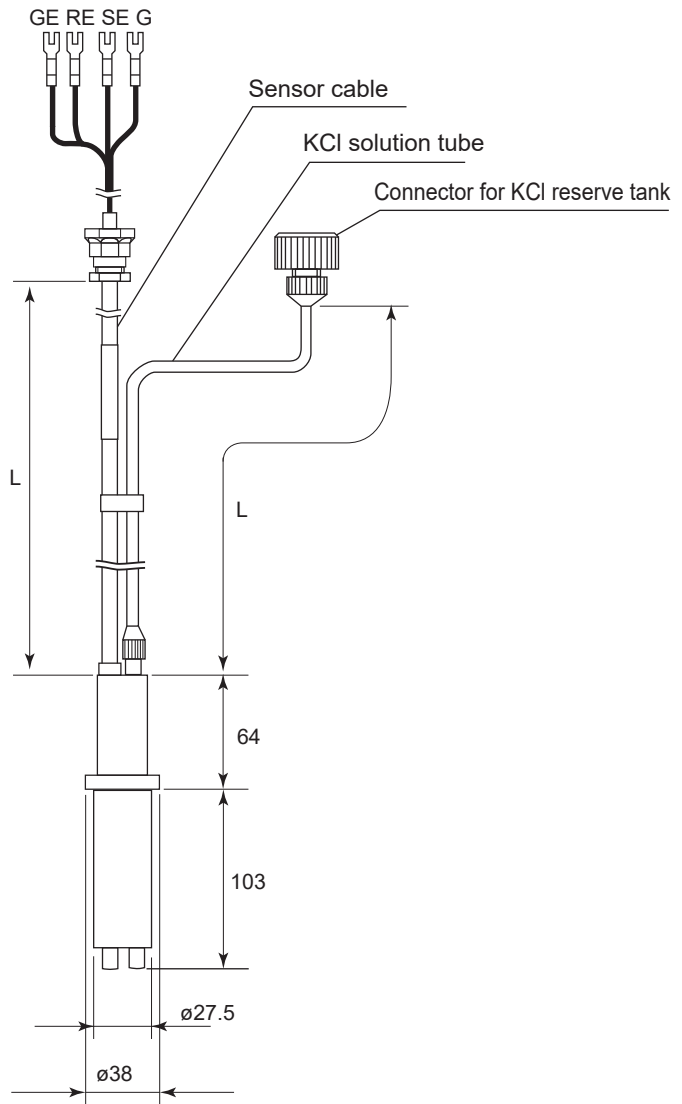

Model and code	L	Weight (kg)
OR8EFG - □□ - 03 - TT□ - □ * A	Approx. 3000	Approx. 0.4
OR8EFG - □□ - 05 - TT□ - □ * A	Approx. 5000	Approx. 0.6
OR8EFG - □□ - 07 - TT□ - □ * A	Approx. 7000	Approx. 0.7
OR8EFG - □□ - 10 - TT□ - □ * A	Approx. 10000	Approx. 1.0
OR8EFG - □□ - 15 - TT□ - □ * A	Approx. 15000	Approx. 1.4
OR8EFG - □□ - 20 - TT□ - □ * A	Approx. 20000	Approx. 1.9

Unless otherwise specified, differences in the dimensions are specified as: General tolerance = ± (Criteria of tolerance class it18 in JIS BO401-1986)/ 2.

Unit : mm

□ General Purpose KCl Reserve Tank  
(OR8EFG - □□ - □□ - TT1 - □ \* A)

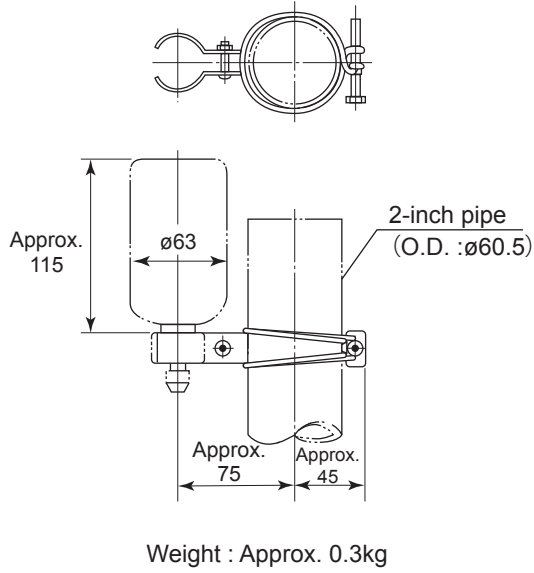

□ Midium Purpose KCl Reserve Tank  
(OR8EFG - □□ - □□ - TT2 - □ \* A)

