

MS821 NEMA1/8DIN

NEMA 4X Enclosure Quick-Release Latch Hinged Cover

Features

- Compact Size: 8"(H) x 6"(W) x 5.75"(D)
- Can Accommodate up to two MINItrol Series Products (1/8 DIN)
- Meets NEMA 4X/IP65 Specs.
- Quick-Release Latches (standard)
- Hinged Cover (on left)
- Light Weight
- Options:
 - Sub Panel
 - DIN Rail
 - Pre-wired to DIN Rail Terminal Block



SPECIFICATIONS:

Height (In.): 8.0
Width (In.): 6.0
Depth (In.): 5.75

Standard Weight (Lbs.): 6.0

Material:

Cover/Base - Ultraguard® Fiberglass reinforced polyester (Color RAL 7035),
Fasteners - 304 series stainless steel,
Back panel inserts - Brass,
Gasket - Closed cell neoprene,
Mounting Feet - 304 series stainless steel

Test Spec:

Construction meets NEMA/EEMAC Type 1, 2, 3, 4, 4X, 12 and 13
UL® 508A listed; Type 1, 2, 3, 3R, 4, 4X, 12, and 13
CSA-C22 No. 14; Type 1, 2, 3, 3R, 4, 4X, 12, and 13
IEC60529 Type IP66

Ordering Information

Part Number

MS821NEMA1/8DIN4X0 (no cutout)
MS821NEMA1/8DIN4X1 (1 cutout)
MS821NEMA1/8DIN4X2 (2 cutouts)

Options:

- A - Assembled at KEP
- SP - Sub-Panel (see drawing)
- DR - Single DIN Rail Installed for accessory mounting
- PW - Internal Pre-wired by KEP to DIN Rail Terminal Block (Consult factory with your requirements)

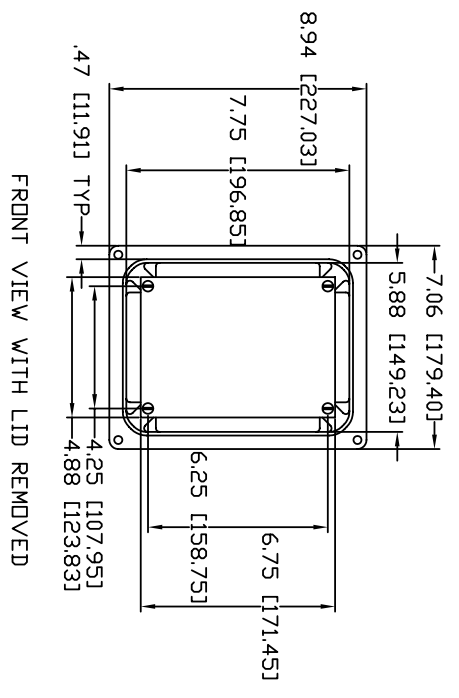
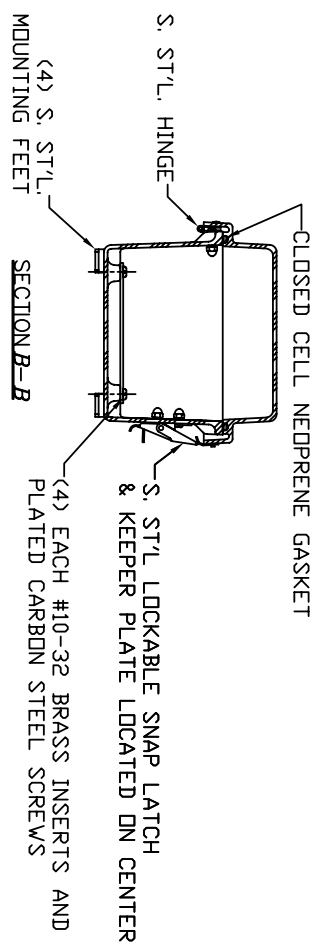
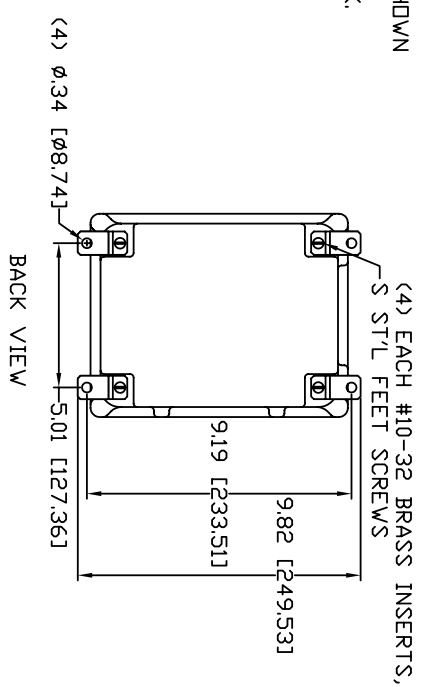
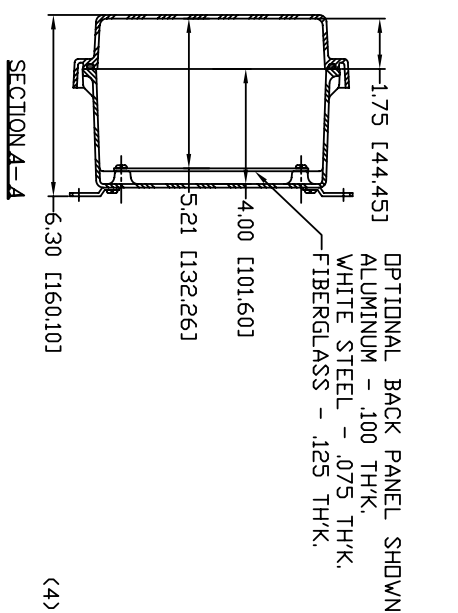
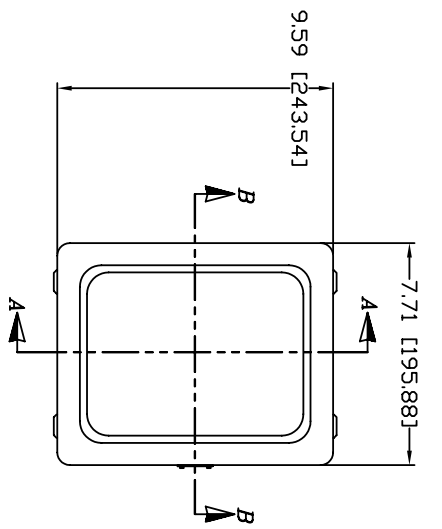

DIMENSIONS:

MATERIAL:
 BOX - COMPRESSION MOLDED FIBERGLASS REINFORCED POLYESTER
 COVER - COMPRESSION MOLDED FIBERGLASS REINFORCED POLYESTER
 WINDOWS - POLYCARBONATE